

Enjoy Life

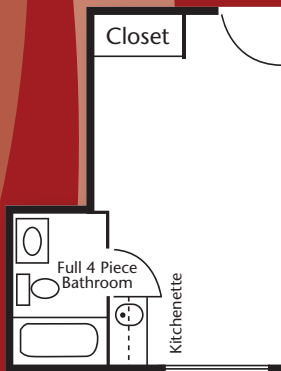

Bedsitting Suite

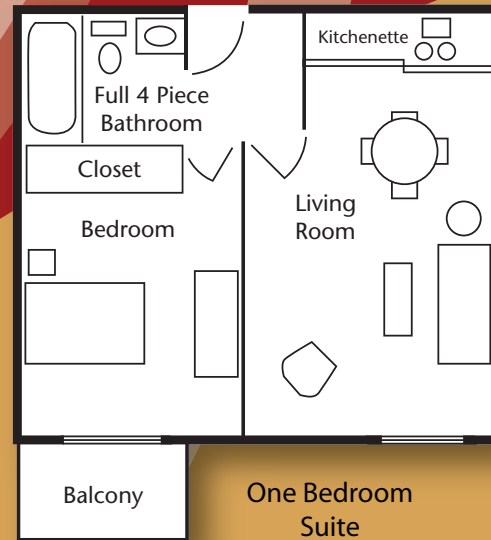

One Bedroom Suite

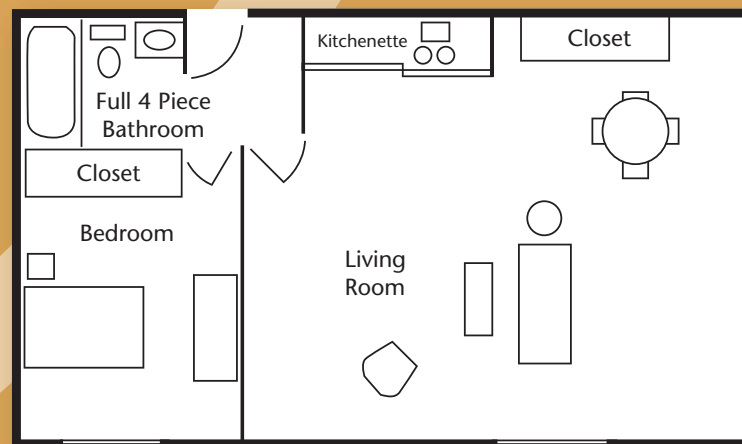

Large Retirement Suite
(Some 2 bedroom Suites)

London's Friendliest Retirement Community



RETIREMENT COMMUNITY

London's Friendliest Retirement Community

Retirement Residence
312 Oxford Street West,
London, Ontario N6H 4N7
Ph: 519.432.1845
Fx: 519.432.7548
www.chelseypark.com



No decision is more important than the place you choose to call home.



The Chelsey Park Retirement Residence at 312 Oxford Street West has achieved the highest level of accreditation with The Ontario Retirement Communities Association by attending to the individual needs and wellness of its residents.

This five storey structure offers comfortable private suites in a variety of sizes where residents enjoy a comprehensive service package. This package includes, but is not limited to, three delicious and nutritional meals a day in an elegant, licensed dining room, three snacks a day are served at the snack centre, housekeeping and laundry service, assistance with medications, bathing, social and recreation programs, emergency call bells connected to 24 hour nursing response and a membership to the Health Club.

Programs and services are tailored to lifestyle preferences and the health care requirements of each individual.



RETIREMENT RESIDENCE

Accommodations & Features

- Comfortable, attractive living quarters in bedsitting, standard and large suites
- En suite 2, 3, or 4 piece bathrooms with low pile broadloom
- Kitchenette with a sink and a refrigerator (excluding studio)
- Individual thermostat controls
- Utilities and air conditioning included (excludes phone and cable services)
- Emergency call bells
- Personal mail boxes, Canada Post mail box in the lobby

Basic Plan for Nursing & Personal Care

- 24 hour emergency nursing response
- Weekly in-suite bathing/showering supervision, toenail trimming (unless diabetic)
- Daily bed making, light bathroom cleaning and disposal of garbage
- Toilet paper, hand soap
- Escort service within the community to and from the Dining Lounge, Health Club and in-house social and recreational programs (evaluation by nurse)
- Medication administration and supervision up to 4 times a day
- Resident conference annually and when necessary (counselling, referrals, family consultation)
- Pre-arrival assessment with Health Services Manager
- Monthly weight monitoring
- On-site Physiotherapy Program available

Housekeeping & Laundry

- Weekly Housekeeping (Bed linens changed weekly)
- Annual interior and exterior window cleaning

- Carpets cleaned annually upon request
- Clean, well maintained buildings and common areas
- Personal laundry and linens washed, dried, folded and delivered weekly (iron available)

Maintenance

- Freshly painted suites in "move-in condition"
- Annual suite inspection for preventative maintenance
- Ongoing repairs and facility upkeep

Meal Plans

- Three nutritional, homemade meals served daily in a beautiful Dining Lounge
- Two Entrée selections at lunch and dinner
- Healthy snacks served three times a day in the Dining Lounge
- Tray service (upon authorization)
- Dining Lounge menus delivered to suites

Amenities & Special Features

Beautifully landscaped grounds surround a well appointed residence. Elegant, licensed dining lounge serving delicious meals open to the public, family and friends.

- Health Club, heated indoor salt water pool, sauna, whirlpool, sun deck and strength training centre
- Wellness Centre (massage therapy and reflexology)
- Social and recreation programs, monthly newsletter, community outings and weekly bus service to Cherryhill Village Mall in an air-conditioned, wheelchair accessible bus
- Personalized "in suite program" for seniors experiencing mobility challenges
- Cheerful, easy access laundry rooms on the 1st, 2nd, 4th and 5th floors

- Wheelchair accessible automated door system at Entrances
- Security door system, fire alarm system
- Computer/craft lounge, library, billiards room, games
- Woodworking room
- Complimentary use of our in-house common lounges for special occasions
- Indoor walkway links the apartment building to the main service area
- Beauty salon
- Drug store, Doctor and Dental Offices
- Chelsey Pantry, Boutique & tea room
- On-site banking
- Close to Cherryhill Village Mall, Cherryhill Medical Building and London Public Library
- City bus stop shelter at main entrance
- Short stay accommodation for visitors, respite, trial convalescent, seasonal/vacation stays in our guest suites (based on availability)
- On-site chapel, monthly denominational church services and transportation to and from community churches

